

Ingoldisthorpe Residents...

Shape the future of your village



Ingoldisthorpe Parish Council is preparing a Neighbourhood Plan. This gives the community a say over future development. A Steering Group has been formed to help the Parish Council to develop a robust and legally compliant plan. A specialist Consultancy has been appointed. **Your opinion matters and we need your views.**

SOME BENEFITS OF A NEIGHBOURHOOD PLAN:

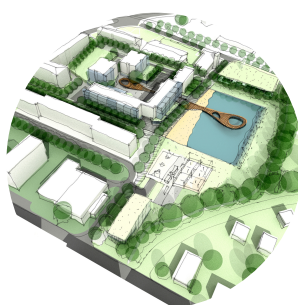

Residents' Control & Influence

A Neighbourhood Plan gives residents an opportunity to have a say in how the neighbourhood develops, ensuring future development aligns with community needs and aspirations.

Planning & Development Guidance

The Plan can produce policies on multiple aspects including housing, design, infrastructure, green spaces, and more. It can influence the type, design and location of developments promoting sustainable growth while protecting valued aspects of the village.

Legal Weight

Once adopted, a Neighbourhood Plan becomes legally binding. The local planning authorities must consider the Plan when making decisions. This carries more weight than other community-led initiatives.

The community survey where we want your views is running between Monday 4th March and Monday 1st April please find an online copy available when scanning the QR code. You can also follow the online link-

<https://www.smartsurvey.co.uk/s/Ingoldisthorpe/>



Hard copies of the survey can be returned to Ingoldisthorpe Church Hall in the drop box. There will also be volunteers available on Saturday 16th March between 10am-12pm to help anyone fill in their forms at the Ingoldisthorpe Sports & Social Club.